

Instantaneous electric water heaters to be fitted to supply hot water to wash hand basins in both new W.C.'s - 1 heater in each room.

Fully recessed vanity type wash hand basin with mono lever tap. hot water supply to the tap is to be regulated to ensure maximum water temperature of 42°

Ceiling mounted light fittings to both W.C.'s to be switched using automatic P.I.R. detectors. both light fittings to be fitted with emergency lighting back up battery packs.

SVP pipe boxing to consist of soft wood framing, 2 layers of 15mm plasterboard and with tiled finish. Void to be filled with mineral wall quilt for sound insulation, boxing to be carried up to ceiling

Purpose made floor to ceiling lockable enclosure to house the existing gas boiler to allow full access to the boiler, pipework and magnetic filter for maintenance.

Timber stud partition walls are to be constructed out of 100 x 50mm treated sawn softwood timber, vertical studs to be at 400mm centres. New stud wall to be taken down through the existing suspended timber floor and constructed off a row of concrete blocks laid flat on a new strip footing. The horizontal studs are to be fixed at 900mm centres, with noggins at mid height and placed in positions to support fittings such as radiators etc.. Partition wall is to be finished with a plaster skim finish externally and tiled internally.

New W/C's to have trapped outlet connected to 100mm diameter pipes, and to be provided, with a wash hand basin with hot and cold running water. Wash hand basins to be provided with 50mm diameter waste pipes laid to falls and 75mm deep seal traps. Where waste pipe runs exceed 4m BBA approved air admittance valves are to be fitted above appliance spill over level. Waste pipes to either discharge below trapped gully grating or into soil and vent pipes via proprietary waste manifolds or bossed junctions. Internally all waste and drainage pipes to have rodding access/eyes at changes of direction and be adequately clipped/supported.

New in line duct mounted extract fan to both W.C.'s to be ducted to discharge to outside air to achieve min.6l/sec. to be switched with lighting and be fitted with adjustable timed overrun.

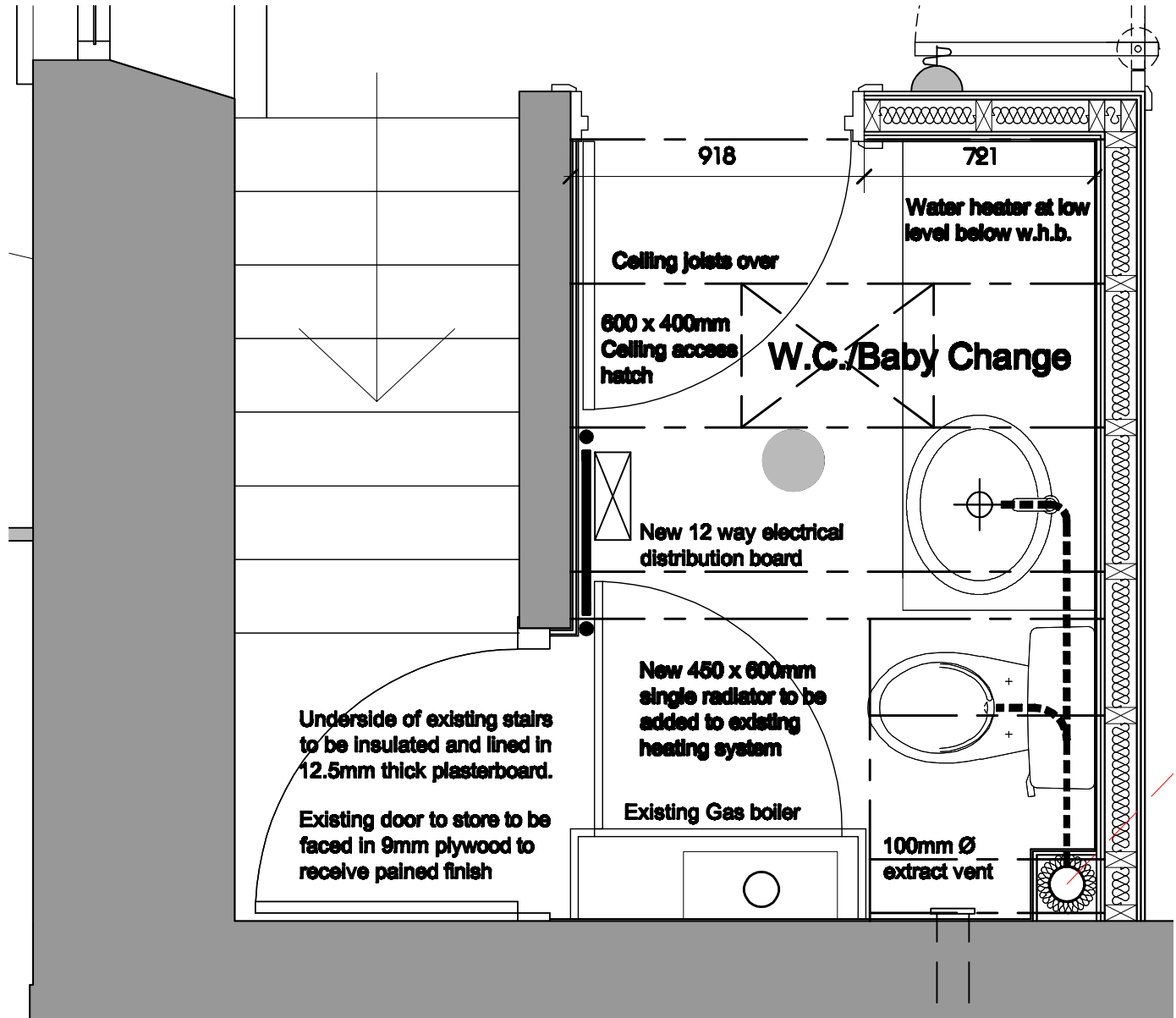

# TENDER - 07.11.2014

Project				
Tabar Baptist Church Building				
For				
Tabar Baptist Church				
Job Number	Drawing Number	Revision	Scale @ 1/4"	Date
152	T - 05		1:20	Nov. 2014